

Rotary Modules

Technical Data – Summary Rotary Modules with external stop

	DM 4-90 AE	DM 4-180 AE	DM 5-90 AE	DM 5-180 AE	DM 6-90 AE	DM 6-180 AE
Angular range of rotation [°]:	0-90°	0-180°	0-90°	0-180°	0-90°	0-180°
Torque M [Nm]:	0,43	0,43	1,08	1,08	3,42	3,42
Axial load Fa [N]:	50	50	200	200	300	300
Radial moment Mr [Nm]:	2	2	10	10	15	15
*Mass moment of inertia [kg cm²]	see diagramme					
Cylinder diameter:	2xØ10	2xØ10	2xØ14	2xØ14	2xØ25	2xØ25
Air consumption per cycle at						
Nominal stroke [Nl]:	0,02/0,03	0,03/0,04	0,05/0,06	0,08/0,09	0,15/0,2	0,25/0,3
Weight DM/DMZ	0,3	0,3	0,8	0,8	1,6	1,6

Rotary modules may only be operated with outgoing air choke.

For all modules

Pneumatic connection: M5
Operating pressure: 4-7 bar
Temperature range: 0-60°C
Repeatability: +/- 0,05°
Angular range of rotation: 45-100°
 variably adjustable
 145-190°
 variably adjustable

Rotary Module 4/5/6 AE



Torques

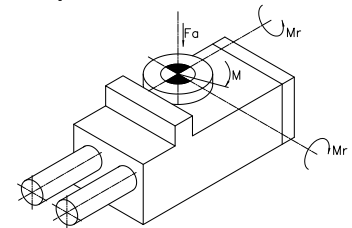

Description for the DM 90° AE

Important:

At the operation of the DM 90° AE you have to turn your attention on the mounting position! The DM 90° AE are going to be delivered in the position 0°, so that the center holes are horizontal to the axis and 90° turn clockwise (see position 90°).

If the DM 90° AE has to turn counterclockwise, the center holes are at right angles to the axis!

This have to be respected stringently for the Positioning/Mounting of grippers etc.

Rotary Module 4/5/6 90 AE
Position 0°

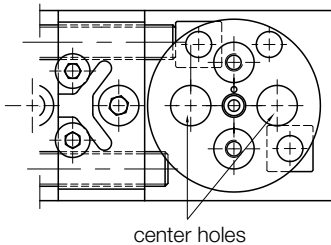

Position 90°

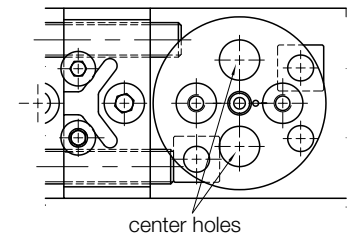

Permissible pivoting time dependent on the mass moment of inertia

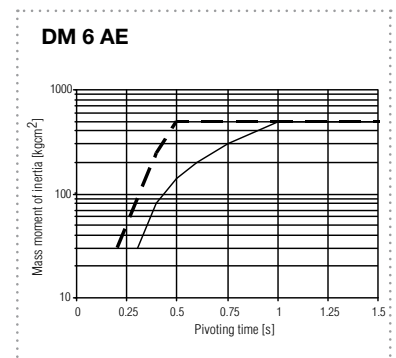
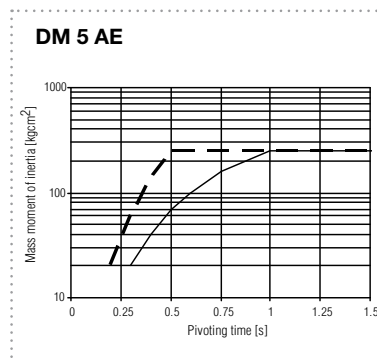
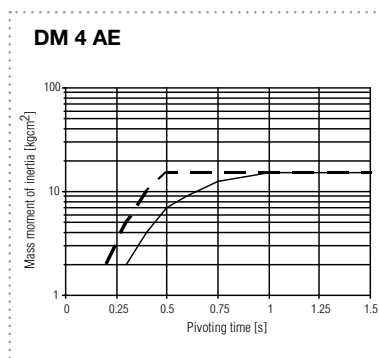

--- 90° ——— 180°

